

Revit Family Information ANGOLO

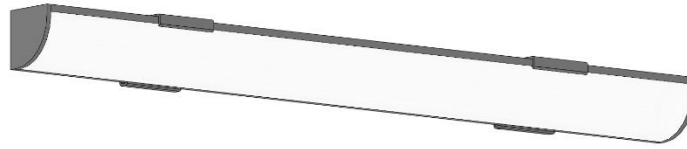

Manufacturer: **Optique Lighting**
File Name: **Lighting-Wall-Optique-Angolo.rfa**
Type Catalog: **Lighting-Wall-Optique-Angolo.txt**
Family Category: **Lighting Fixtures**
Software: **Revit 2020**
IES: **Available**
Host: **Face ***

* Face based (as opposed to ceiling or wall based) components can be recognized in both architectural and engineering Revit project files

Pre-loaded Types:

Family Types

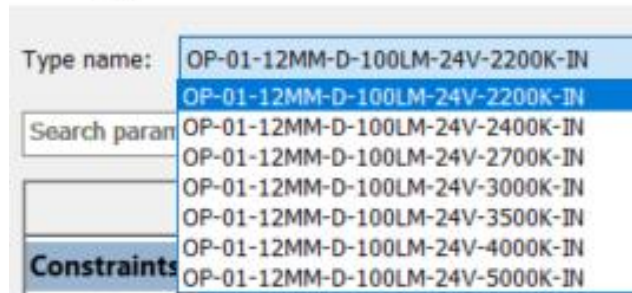

(type catalog can be used to load more types)

Adjustable Parameters (Instance Parameters):

Length – *input preferred length*

Mounting Clip – *select if fixture will be mounting using mounting clip*

VHB Adhesive – *select if fixture will be mounted with double sided tape*

No Mounts – *installer can either screw or use own adhesive to mount; will automatically be selected if parameters Mounting Clip and VHB Adhesive are unselected*

Materials & finishes

Electrical

Photometrics